

D-14
AAFBMAGD14L115
VOCs BAL
D-14
AAFBMAGD14L116(DUP)
VOCs BAL

MW-1
AAFBMAGMWIL117
VOCs BAL

IRP-61
AAFBMAG61L132
VOCs ND
IRP-61
AAFBMAG61L133(DUP)
VOCs ND

IRP-30
AAFBMAG30L103
VOCs ND

GPA-2
AAFBMAGG2L106
VOCs BAL

GPA-1
AAFBMAGG1L107
TCE 5.2

IRP-31
AAFBMAG31L108
TCE 370

IRP-14
AAFBMAG14L102
VOCs BAL

IRP-29
AAFBMAG29L104
PCE 5.3
IRP-29
AAFBMAG29L105(DUP)
PCE 5.2

LEGEND:

- EXISTING AIR FORCE PROPERTY LINE
- EXISTING BUILDING
- EXISTING ROADS
- EXISTING UNIMPROVED ROADS
- INSTALLATION RESTORATION PROGRAM (IRP) SITE
- SHALLOW MONITORING WELL
- DEEP MONITORING WELL
- FULL SCREENED MONITORING WELL ACROSS THE WATER TABLE
- PRODUCTION WELL
- BOREHOLE LOCATION

SAMPLE LOCATIONS IN RED EXCEED MCLs

IRP-31	WELL ID
AAFBMAG31L108	SAMPLE ID
TCE 370	VOCs, ug/L

BOLDED VALUES EXCEED MCLs
 BAL - BELOW ACTION LEVELS
 ND - NOT DETECTED
 ug/L - MICROGRAM PER LITER
 PCE - TETRACHLOROETHENE
 TCE - TRICHLOROETHENE

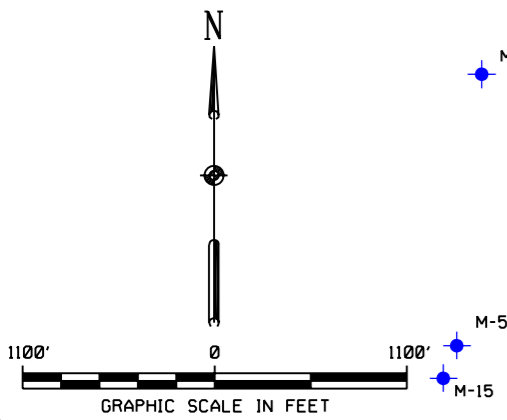

Figure 2-1.
 Spring 2008 Groundwater Analytical Results for MARBO Operable Unit, Andersen AFB, Guam.